

MagTube Rifle Mounting Tutorial

Dear Player,

Thank you for choosing the best Virtual Reality stock rifle solution. We invite you to join our [Discord](#) community for any questions or directly contact us through our [support service](#) on [our website](#).

You can find some video tutorials of this mounting [in real life video](#) and [in 3D version](#) on our [YouTube ProTubeVR channel](#) in the "mounting tuto" playlist.

To build your MagTube rifle, please follow the next steps.

🕒 Build your MagTube should take around 1.5 hour.

First, make sure you work on a clear area and be very careful. Some parts are small and get lost easily.



PROTUBE VR
FEEL THE GAME

Step 1: Back end

You will need: bag n°1, smallest tube and back end.

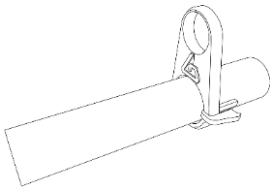

1.a- Put the wedge on the ring and put them both on the smallest tube.

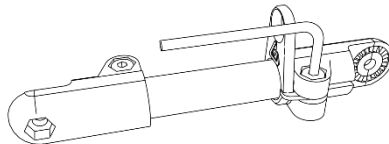

1.b- Put the two connections with internal notches on each part of the small tube and screw them with the Hex key.

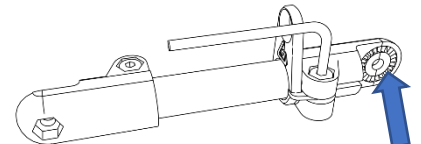

1.c- Apply some oil all around the notches on the connection which is the nearest from the ring.

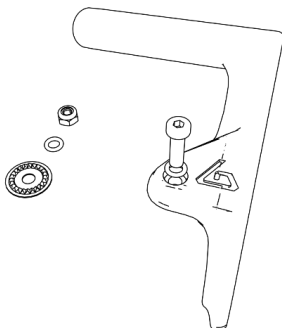

1.d- Put one O'ring on the 20mm screw, slot them both into the hole provided in the back end.

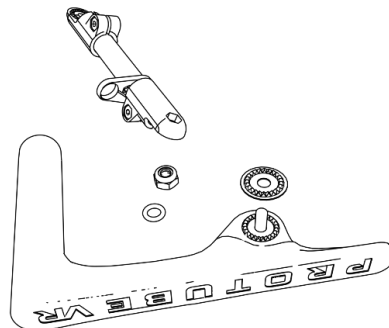

1.e- Then slide the notched washer (the notches have to be facing the same way) and the previously oiled connection over the screw.

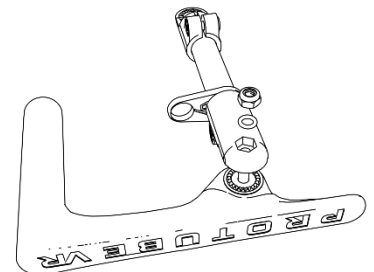

1.f- Attach the screw securing the stock and the connection with one O'ring and the nut.

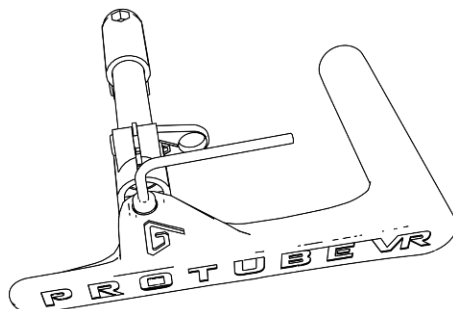

1.g- Screw all the pieces together taking care not to over tighten. You must be still able to rotate the back-end by force.

Step 2: Back side

You will need: bag n°2, medium tube and notched magnetic bracket.

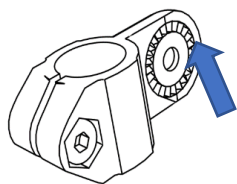

2.a- Apply some oil all around the notches on the T-notched connection.

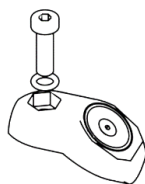

2.b- Put one O'ring on the 20mm screw, slot them both into the hole provided in the notched magnetic bracket.



2.c- Then slide the notched washer and the previously oiled T-notched connection over the screw.

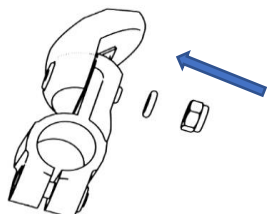

2.d- Attach the screw securing the notched magnetic bracket and T-notched connection with one O'ring and the nut.

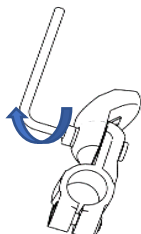

2.e- Screw all the pieces together taking care not to over tighten. You must be still able to rotate the two parts by force.

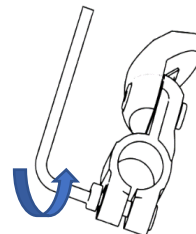

2.f- Unscrew the 18mm screw at the base of the T-notched connection. You will need it at the step 2.i).

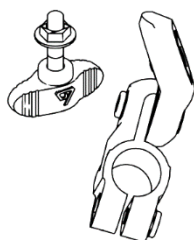

2.g- Set the butterfly screw on the hex washer.

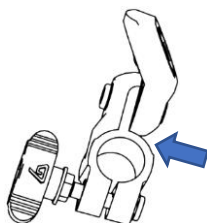

2.h- Screw the butterfly with the Hex screw to a nut on the other side.

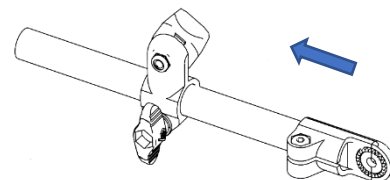

2.i- Slide the medium tube into the T-notched connection.

- If you aim with the right eye, the magnet must be facing right side.
- If you aim with the left eye, the magnet must be facing left side.

Then place the external notches connections on both side of the tube.

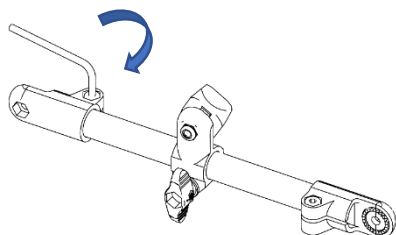

2.j- Finally screw the two external notched connections on the tube.

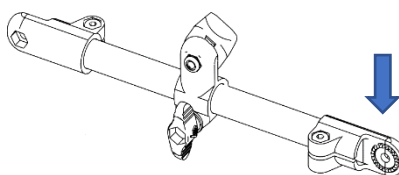

2.k- Apply some oil all around the external notches of the rear side.

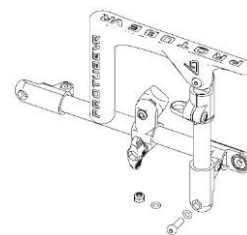

2.l- Place one O'ring on the 18mm screw (the one from 2.f). Slide them both through the internal notched connection and the external connection.

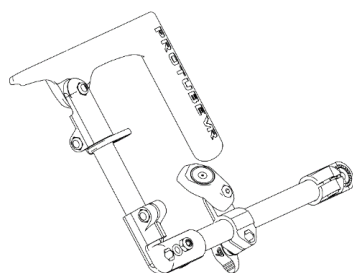

2.m- Attach the screw securing both connection with one O'ring and the nut.

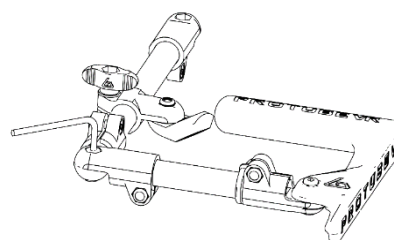

2.n- Screw all the pieces together taking care not to over tighten. You must be still able to rotate the two parts using force.

Step 3: Front side

You will need: bag n°3M, longest tube and smooth magnetic bracket.

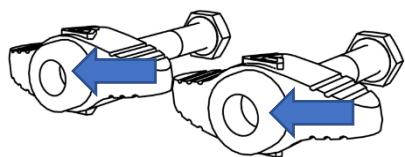

3.a- Apply a dot of oil on the base of the butterfly part and attach each butterfly with one Hex screw.

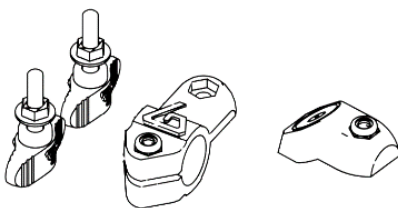

3.b- Remove the 18mm screw on the T-notched connection. You will need it at step 3.j.
Put the hex washers on the butterfly screws.
Put one nut on the T-notched connection and one on the smooth magnetic bracket.

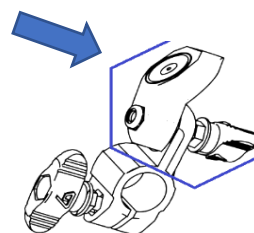

3.c- Slot one butterfly screw into the hole provided on top of the T-notched connection.
Then slot into the rubber washer.
Then slot into the smooth magnetic bracket.
Finally, secure with a nut.

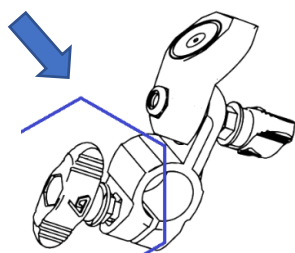

3.d- Slide the other butterfly screw through the T-notched connection on the none-logo side.
Secure with the nut previously installed in 3.b.

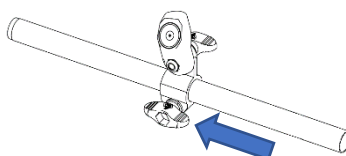

3.e- Put the previously assembled part through the longest tube.

- If you aim with the right eye, the magnet must be facing left side.
- If you aim with the left eye, the magnet must be facing right side.

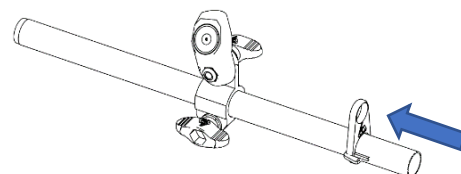

3.f- Put the wedge on the ring and slide them through the back of the tube.

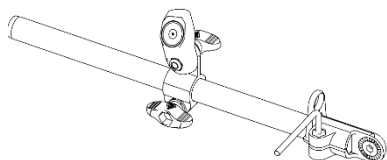

3.g- Put the connection with internal notches on the tube and screw it with the Hex key.

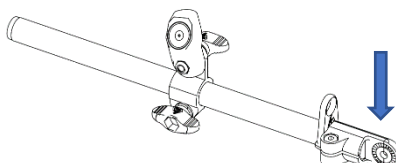

3.h- Apply some oil around the internal notches.

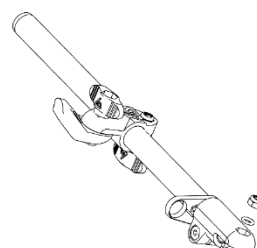

3.i- Place one O-ring and the nut on the internal notched connector.

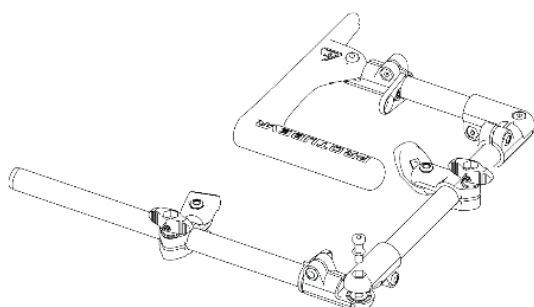

3.j- Place one O-ring on the 18mm screw previously removed from the T-notched connector (step 3.b).
Slide them both through the external notched connection and the internal connection.
Secure it with the nut on the other side.

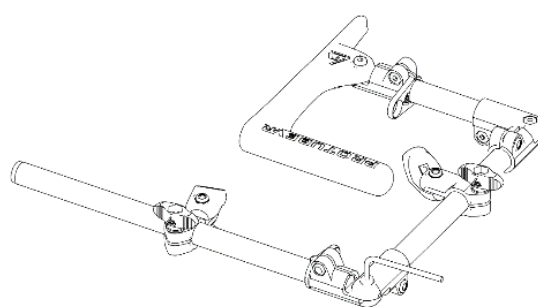

3.k- Screw all the pieces together taking care to not over tighten.
You must be still able to rotate the two parts by force.

Your **MagTube** is now mounted.

Step 4: Adjustment

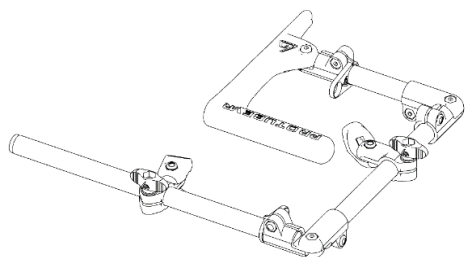

4.a- Bend all the connections at an angle of 90° so that the MagTube Rifle almost forms a square.

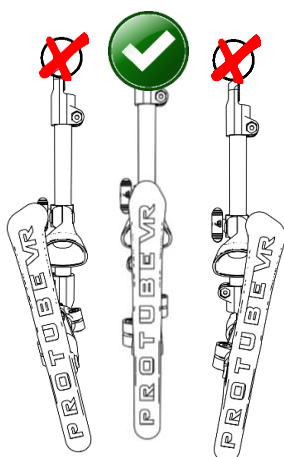

4.b- Adjust the medium tube with the top of the stock and tighten a bit more the screw (2.n).

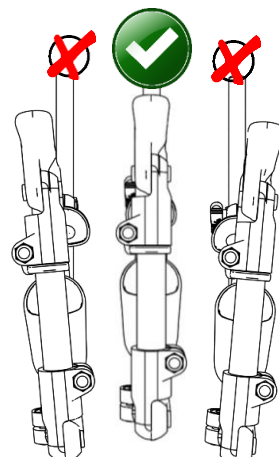

4.c- Adjust the long tube with the rear of the butt and tighten a bit more the screw (3.j).

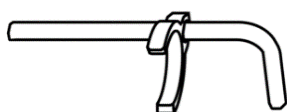

4.d- Slide the hex key through the clip, so you can clip it on your MagTube for later adjustments if needed.

Step 5: Final touch

Now you can magnetically attach the MagCups to the black magnetic holders.

Make sure the logo on the cups are facing the front of the Rifle.

Now, you can remove the hand straps of your controllers and replace them with the ProTubeVR ones.

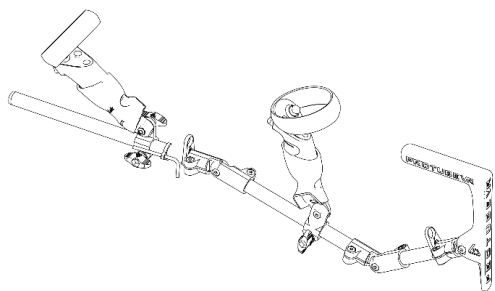

Congratulation!

Your MagTube rifle is now operational!

As a reminder, your MagTube will highly improve your freedom, your reaction time and your efficiency after some training, the time you get used to it.

If you have chosen the Valve Index brand for your MagTube, you can see how to set up your controllers on our video (["How to setup your Knuckles cups"](#) on Youtube).

Feel the game!
ProTubeVR team